

Product datasheet

Specifications



Illuminated LED unit for modular tower lights, yellow, Ø60, blinking, IP65, 24 V AC/DC

XVUC48

! Discontinued

Main

| | |
|------------------------------------|--|
| Range Of Product | Harmony XVU |
| Product Or Component Type | Modular tower light |
| Beacon Or Indicator Bank Unit Type | LED unit |
| Mounting Diameter | 60 mm |
| Component Name | XVU |
| Light Source | LED, yellow |
| Device Application | Automotive Packaging machine Machine tools |

Complementary

| | |
|--------------------------------|--|
| Signalling Type | Blinking |
| Assembly Style | Customer assembly, up to 5 units Up to 4 units with buzzer |
| Material | PC (polycarbonate) V-2 conforming to UL 94 PC (polycarbonate) V-0 conforming to UL 94 |
| [Us] Rated Supply Voltage | 24 V AC/DC |
| Maximum Power Dissipation In W | 1.2 W |
| Signalling Type | Blinking |
| Length | 50 mm |
| Net Weight | 0.064 kg |

Environment

| | |
|---------------------------------------|-----------------|
| Product Certifications | CE UL CSA |
| Ambient Air Temperature For Storage | -40...70 °C |
| Ip Degree Of Protection | IP65 |
| Ambient Air Temperature For Operation | -25...50 °C |
| Vibration Resistance | 2 gn |

Packing Units

| | |
|------------------------|-----|
| Unit Type Of Package 1 | PCE |
|------------------------|-----|

Disclaimer: This documentation is not intended as a substitute for and is not to be used for determining suitability or reliability of these products for specific user applications

| | |
|------------------------------|----------|
| Number Of Units In Package 1 | 1 |
| Package 1 Height | 9.0 cm |
| Package 1 Width | 9.1 cm |
| Package 1 Length | 13.3 cm |
| Package 1 Weight | 143.0 g |
| Unit Type Of Package 2 | S03 |
| Number Of Units In Package 2 | 24 |
| Package 2 Height | 30 cm |
| Package 2 Width | 30 cm |
| Package 2 Length | 40 cm |
| Package 2 Weight | 4.034 kg |
| Unit Type Of Package 3 | P06 |
| Number Of Units In Package 3 | 192 |
| Package 3 Height | 75 cm |
| Package 3 Width | 60 cm |
| Package 3 Length | 80 cm |
| Package 3 Weight | 40 kg |

Sustainability



Green Premium™ label is Schneider Electric’s commitment to delivering products with best-in-class environmental performance. Green Premium promises compliance with the latest regulations, transparency on environmental impacts, as well as circular and low-CO₂ products.

Guide to assessing product sustainability is a white paper that clarifies global eco-label standards and how to interpret environmental declarations.

[Learn more about Green Premium >](#)

[Guide to assess a product’s sustainability >](#)



Transparency RoHS/REACH

Well-being performance

✓

Mercury Free

✓

Rohs Exemption Information

Yes

Certifications & Standards

| | |
|--------------------------|--|
| Reach Regulation | REACH Declaration |
| Eu Rohs Directive | Pro-active compliance (Product out of EU RoHS legal scope) |
| China Rohs Regulation | China RoHS declaration |
| Environmental Disclosure | Product Environmental Profile |
| Circularity Profile | End of Life Information |

Dimensions Drawings

Illuminated LED Unit

Dimensions

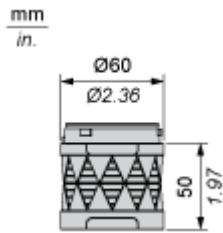

Mounting and Clearance

Modular Tower Lights Mounting

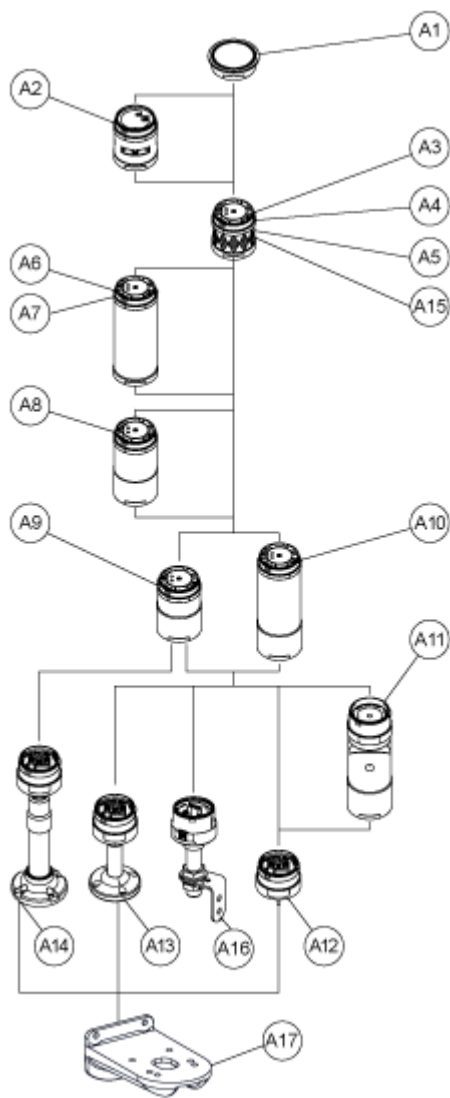

| Drawing | Part number | Part name |
|---------|-------------|----------------------|
| A1 | - | Top cover |
| | - | Top cover (Silver) |
| A2 | XVUC9S | Buzzer unit |
| | XVUC9SQ | Buzzer unit (Silver) |
| A3 | XVUC23 | Green LED unit |
| | XVUC24 | Red LED unit |
| | XVUC25 | Orange LED unit |
| | XVUC26 | Blue LED unit |

Product datasheet

XVUC48

| Drawing | Part number | Part name |
|---------|-------------|---|
| | XVUC27 | White LED unit |
| | XVUC28 | Yellow LED unit |
| A4 | XVUC29 | Multi-LED unit |
| A5 | XVUC29P | Multi-LED unit, Pulse signal |
| A6 | XVUC9V | Sound unit |
| A7 | XVUC9VP | Sound unit, Pulse signal |
| A8 | XVUC020 | Extender |
| | XVUC020Q | Extender (Silver) |
| A9 | XVUC21B | DC body |
| | XVUC21BQ | DC body (Silver) |
| A10 | XVUC21M | AC body NPN |
| | XVUC21MP | AC body PNP |
| | XVUC21MQP | AC body PNP (Silver) |
| A11 | XVUZ06 | Flexible option |
| A12 | XVUZ01 | Fixing Unit - Direct mounting (3 pins) |
| | XVUZ01Q | Fixing Unit - Direct mounting (Silver,3 pins) |
| | XVUZ03 | Fixing Unit - Direct mounting (2 pins) |
| | XVUZ04 | Fixing Unit - Direct mounting (4 pins) |
| A13 | XVUZ02 | Fixing Unit - Plate with Pole (100 mm) |
| | XVUZ02Q | Fixing Unit - Plate with Pole (100 mm, Silver) |
| | XVUZ400 | Fixing Unit - Plate with Pole (400 mm) |
| | XVUZ800 | Fixing Unit - Plate with Pole (800 mm) |
| A14 | XVUZ05 | Fixing Unit - Plate with adjustment pole (100-385 mm) |
| A15 | XVUC43 | Green LED unit, Flash |
| | XVUC44 | Red LED unit, Flash |
| | XVUC45 | Orange LED unit, Flash |
| | XVUC46 | Blue LED unit, Flash |

| Drawing | Part number | Part name |
|---------|-------------|--|
| | XVUC47 | White LED unit, Flash |
| | XVUC48 | Yellow LED unit, Flash |
| A16 | XVUZ100T | Fixing Unit - Metal bracket with pole (100 mm) |
| | XVUZ250T | Fixing Unit - Metal bracket with pole(250 mm) |
| | XVUZ400T | Fixing Unit - Metal bracket with pole (400 mm) |
| A17 | XVUZ12 | Fixing plate for use on vertical support - black |

Connections and Schema

Illuminated Units, Multi-LED and Audible Units Wiring

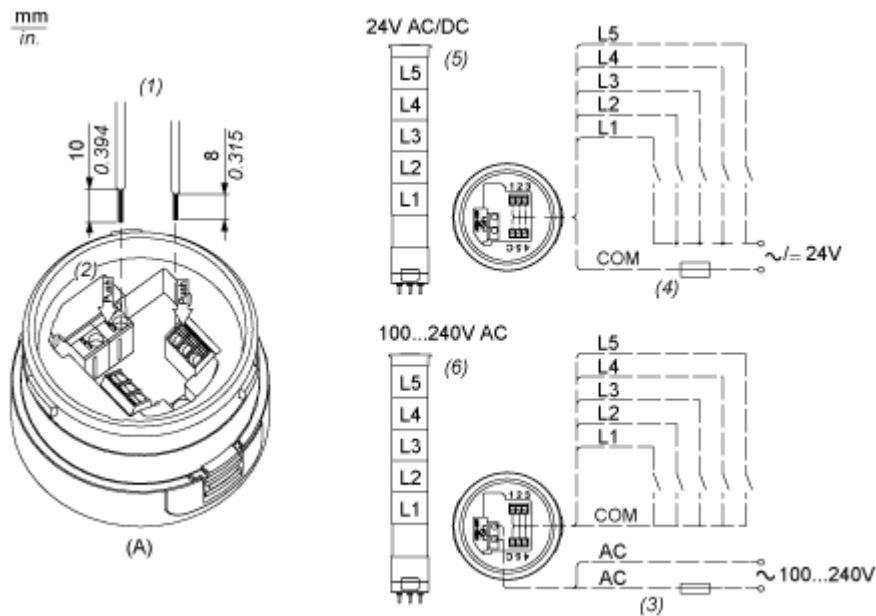

- (A) Fixing Unit
 - (1) Dimensions of Wiring size
 - (2) Push-in Wire Connectors
 - (3) Fuse : 2A ,250V
 - (4) Fuse : 0.5A ,125V
 - (5) Modular Tower Lights 24V AC/DC
 - (6) Modular Tower Lights 100...240V AC
- L1 to L5 : Illuminated LED Units